

# Racing Bantam Drive-side Crank Half.

Material EN24T. Surface harden after machining to 45 rockwell, to depth of 20 thou max and check all sizes and regrind where necessary.

Reduce crankpin length evenly both sides to 50.30 mm.

Crankpin Hole 0.5 thou to 0.75 thou Interference fit  
 Fine surface ground finish hole on 27.25 centre and parallel to mainshaft.  
 Side float on conrod 2.0mm

Use Rd400 Conrod assembly with this crank.

Stroke 54.50mm

Sizes in mm. **DO NOT SCALE.**

(Except where stated Differently.)

Small end use Wiseco B1038 with Yz125 98-01 piston

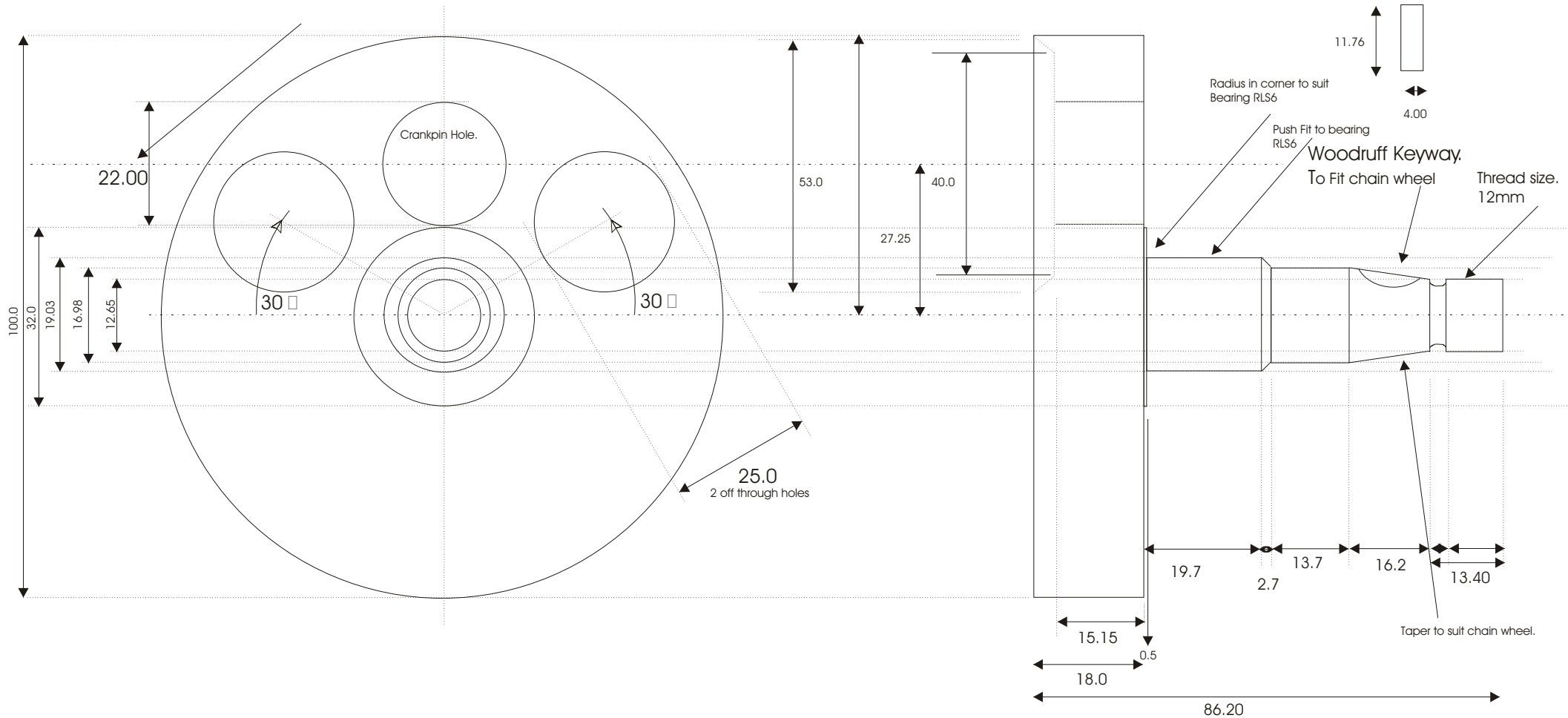

Hidden detail of balance holes missed off for clarity on this side of drawing.